





Local road network and public open space is indicative only and subject to change and refinement at subdivision stage.

**LEGEND**





**ZONES**

-  Residential R25
-  Residential R30
-  Residential R40
-  Residential R60

**RESERVES**

-  Parks & Recreation
-  Public Purpose
-  PS Primary School
-  Industrial Business

**OTHERS**

-  Neighbourhood Connector
-  Access Road
-  132Kv Transmission Line Realignment  
(Subject to final approval from Western Power)
-  Dampier to Bunbury High Pressure Gas Pipeline 200m Buffer

Note:  
The access road layout is indicative only and subject to refinement as part of the detailed subdivision design process.

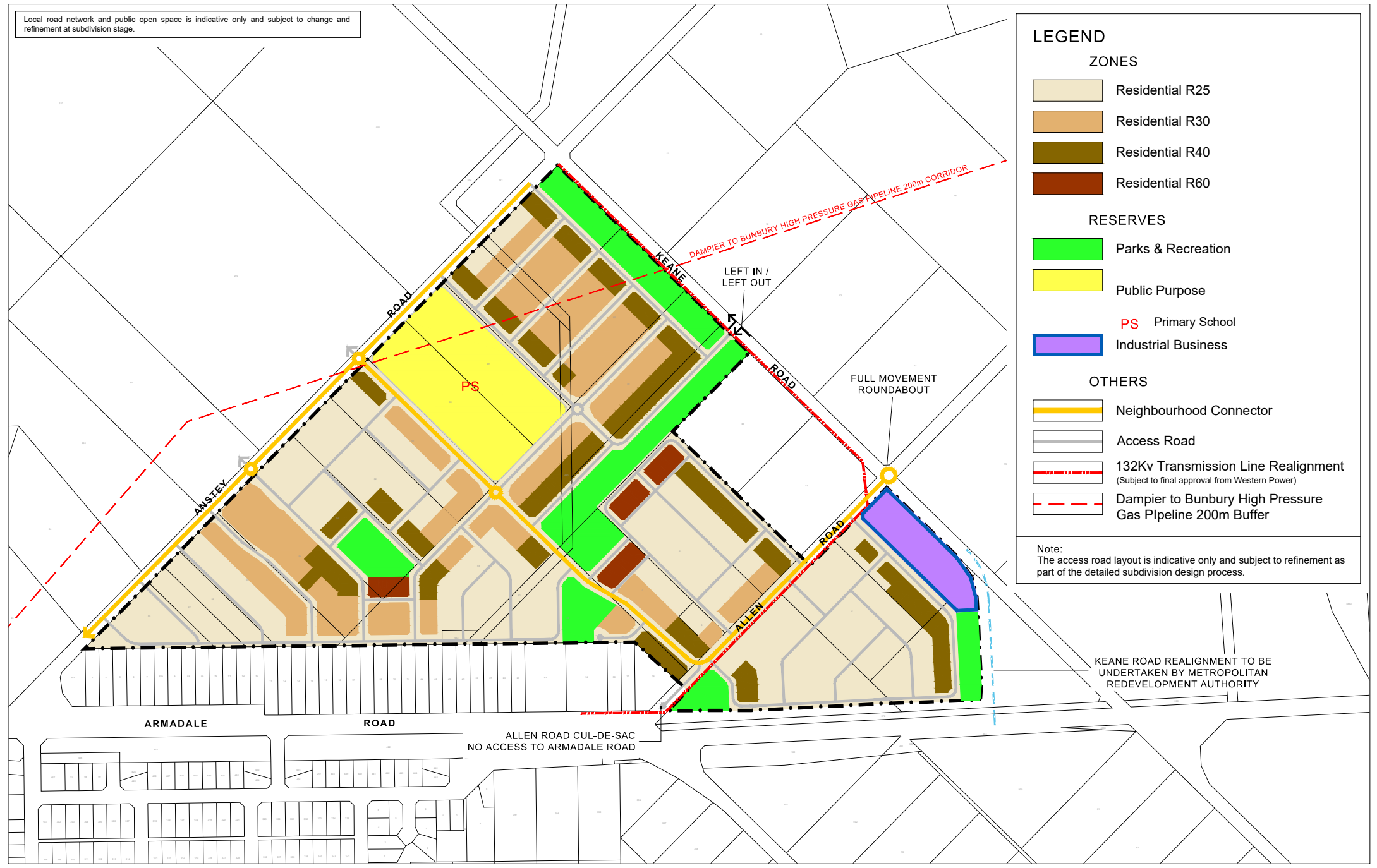

KEANE ROAD REALIGNMENT TO BE UNDERTAKEN BY METROPOLITAN REDEVELOPMENT AUTHORITY

